



29 Sunset Drive Garden Island Creek TAS

3 1 2

Positioned in a lovely seaside setting within a peaceful little community, this gorgeous holiday home or permanent residence is just across from the walkway directly to a family-safe beach. The home offers a large open plan living with 2 or 3 good sized bedrooms all with built-ins, and a lovely central bathroom. Recently renovated, it is a bright and airy home. There are beautiful established gardens, with a bore & both a carport & shed too.

The owners have thought of everything here. Extremely well maintained and very well thought out inside and outside, there really is nothing to do except enjoy the property. There are new tanks totalling 15,000L and a bore in the garden with quality Davey pressure pumps supplying clean rainwater to the house and good ground water for the gardens.

The shed at the rear is big enough to store a boat and all

Building Size : 94 sqm
Land Size : 678 sqm
View : <https://www.taspr.com.au/214083>



Maree Oost
03 6264 2888

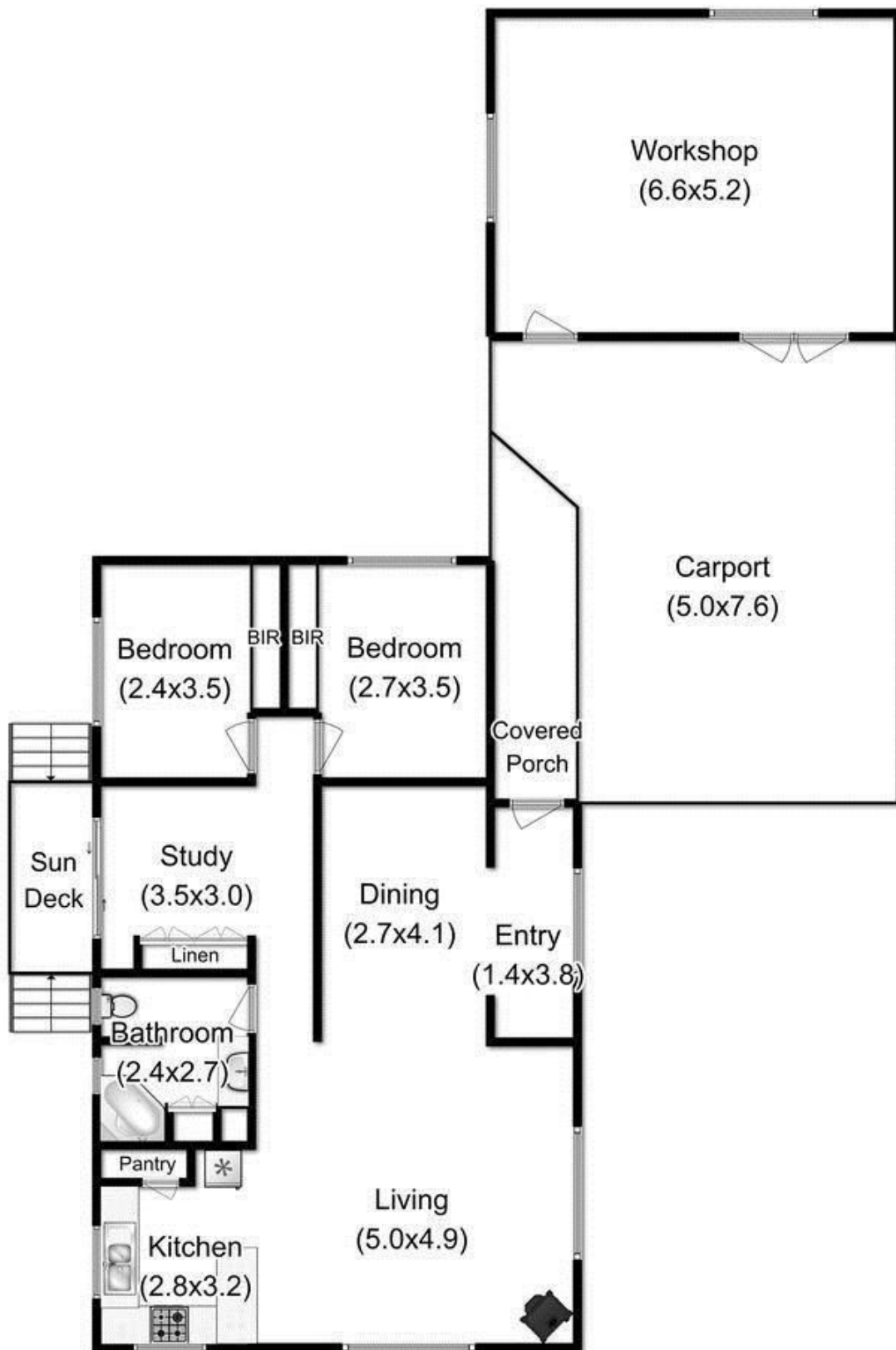

Total Approx. Floor Area : 97.7 m²

Approx. Outbuilding Area : 34.3 m²

Fixtures & Fittings for display purposes only, not to scale
Produced by Open2view.com