



## 1229 Pelverata Road Pelverata TAS

2 1 4

Located in an area of outstanding beauty is this well maintained brick home set well back from the road on over 5 acres of improved north facing pasture with a dam and a small area of bushland including magnificent mature gum trees. The property includes a scenic winter creek which flows through the dam and has been known to home platypus in recent years.

The house has undergone extensive recent improvements including new insulation, upgraded kitchen appliances, updated bathroom, new wood heater and reverse cycle air conditioner and to top it off, it has just been painted throughout. The home is all on the upper level with the living, dining and kitchen all facing north. The ground level easily lends itself to a quick conversion for additional bedrooms or independent living. Externally the home has established gardens and fruit trees, a great entertaining

**Building Size** : 84 sqm  
**Land Size** : 21500 sqm  
**View** : <https://www.taspr.com.au/3402716>



**Maree Oost**  
**03 6264 2888**

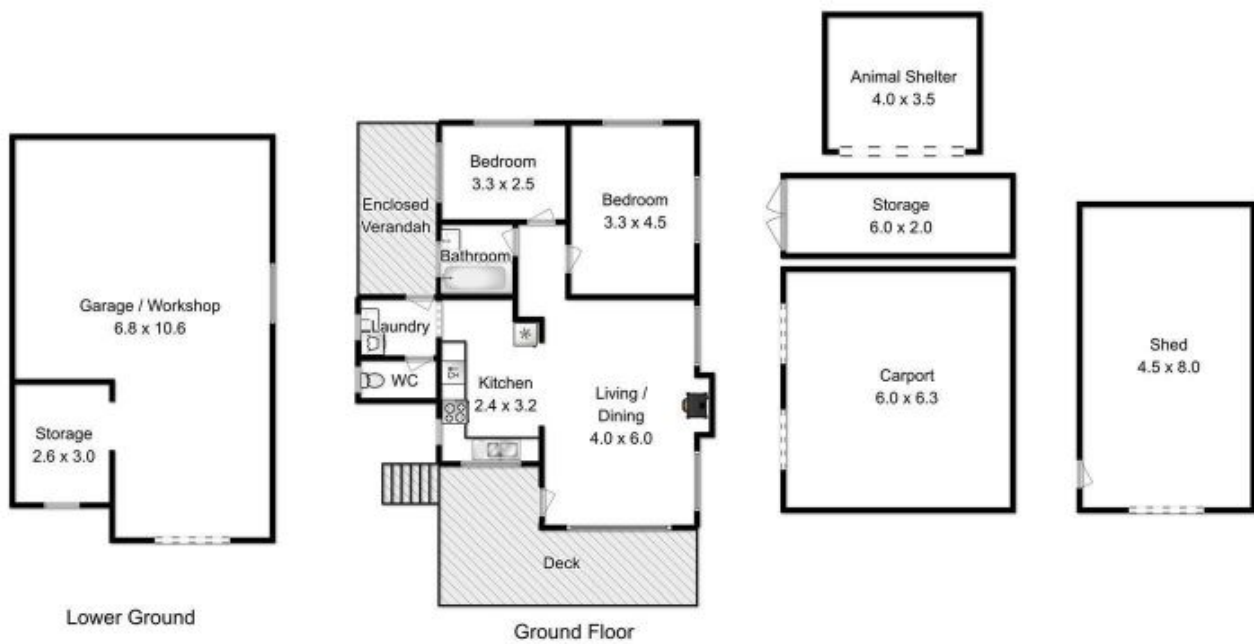

Approx. house area: 146 sqm (inc. lower ground floor)  
Approx outbuilding area: 102 sqm

Fixtures and fittings are for display only and not to scale.  
All measurements are internal and approximate.  
This plan is a sketch for illustration, not valuation.  
Produced by Open2view.com

