

### 6696 Channel Highway Deep Bay TAS

3 1 3

This delightful cottage is situated near the waters of Deep Bay. The home comprises open plan kitchen, dining and lounge with a sliding door onto front deck to sit and enjoy views out over the water and rolling hills beyond. 2 double bedrooms and 1 bathroom/laundry combined. Under the main roof is a large lined garage with an extra bedroom and rumpus room with a wood-heater and sliding doors into the private undercover verandah. Situated on easy care, level 668m2 block that has been used wisely with two good sized garden sheds on concrete slabs, established garden and fruit trees of apricot and plum with new 5 gallon poly water tank. Only a short 5 minute stroll to Deep Bay jetty and launching ramp and close proximity to pristine beaches, great fishing and water activities. Located approx. 7 minutes drive to the township of Cygnet, well known for arts, music, boating and sustainable living are just some of the key interests of the residents of Cygnet and its

**Building Size** : 94 sqm  
**Land Size** : 668 sqm  
**View** : <https://www.taspr.com.au/3409133>



**Maree Oost**  
**03 6264 2888**

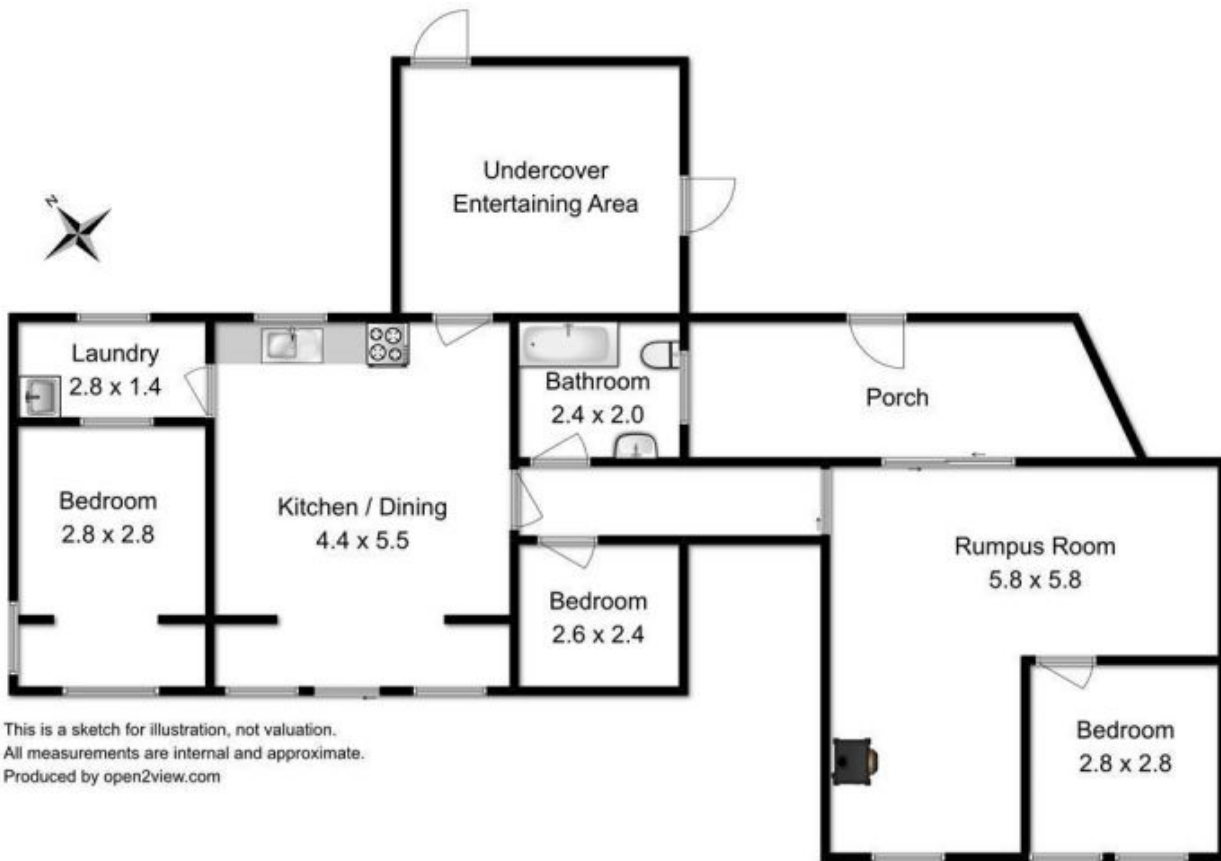
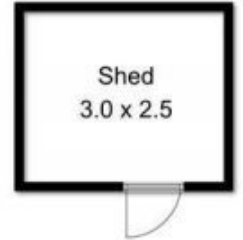
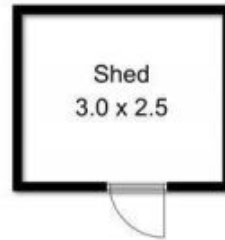

This is a sketch for illustration, not valuation.  
All measurements are internal and approximate.  
Produced by open2view.com

Total approx. floor area : 94 sqm