



116 Garden Island Creek Road Garden Island Creek TAS

2  1  6 

This warm and inviting 2+ bedroom, 1 bathroom timber clad cottage is located on 4.96 hectares (12.25 acres) of land that is perfect for horses. The home has a huge master bedroom with built in wardrobes and a second double bedroom with raked timber ceilings and built in robes. There is an option to complete lining the large rear boot/store room to convert into a third bedroom if required. The home has a large kitchen and dining area with an under bench stove and induction cooktop, it has access to an undercover deck area. The lounge is large and inviting with a Saxon wood heater and slate hearth. At the rear of the home you have a family bathroom and laundry with access to outside.

The land is mostly level to a slight slope that lends itself to horses, you have an old timber barn that houses a stable and TAC area, meandering horse trails, paddocks without

Building Size : 139 sqm
Land Size : 49600 sqm
View : <https://www.taspr.com.au/3846443>



Maree Oost
03 6264 2888

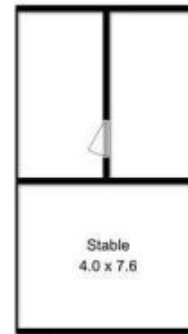
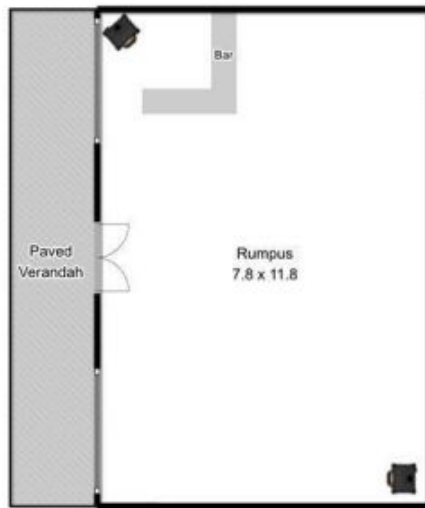

tpr property group

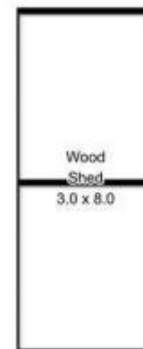

Approx. House Floor Area: 195 Sqm



Fixtures and Fittings are for display only and not to scale.

This floor plan is a sketch for illustration.

All measurements are internal and approximate.

Produced by open2view.com