





15 Port View Drive Port Huon TAS

3  2  4 

Immaculate home just over 12 months old, conveniently located amongst newly built homes and within walking distance to Port Huon Bay, services, hotel, marina, bus stop and recreational parks. The open plan living is light and bright with floating floorboards and views out to the Bay. The modern kitchen has plenty of cupboard space, pantry and an island bench with impressive pendant lights overhead. Connected to all town services with NBN available and data points in the living room and main bedroom.

The main bedroom offers a walk in robe and tiled ensuite whilst bedrooms 2 & 3 have built in robes with the spacious tiled family bathroom close by.

A sliding door leads from the dining room to the rear timber deck for ease of entertaining with guests. There is a double

Price : \$ 543,000
Building Size : 97 sqm
Land Size : 659 sqm
View : <https://www.taspr.com.au/7866736>



Maree Oost
03 6264 2888

THIS PLAN IS ADAPTED BY:

PLEASE NOTE: no variations will be permitted after plans are signed by the client (with exception of Council requirements / approvals).
SIGNATURE: _____
DATE: _____

Floor Area – 97.7m²
Porch Area – 3.2m²
Deck Area – 14.9m²

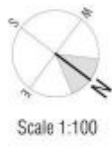
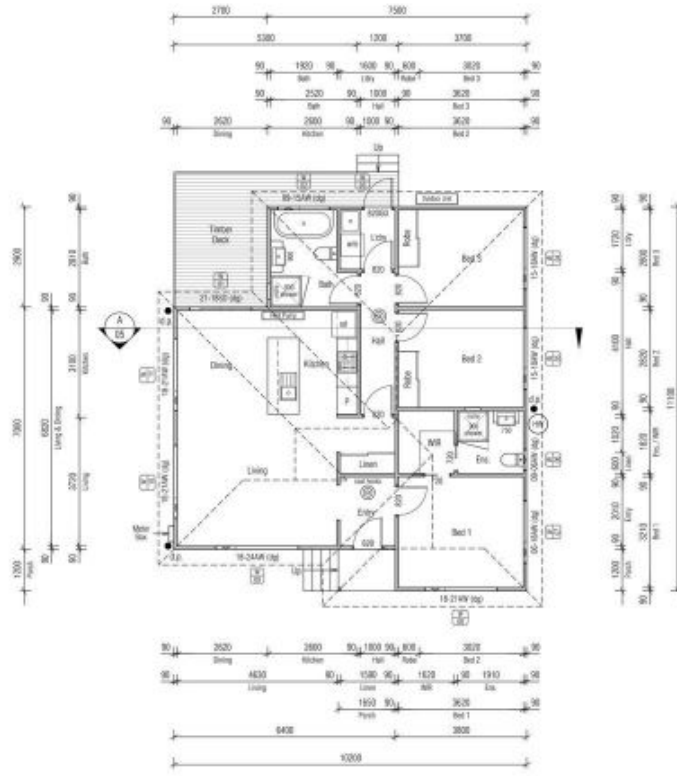

PROPOSED DWELLING FOR STYLES
AT Lot 15, PORT VIEW DRIVE, PORT HUON

BAL-TBA
See sheet 13 for
Bushfire Attack Level
construction requirements

© This document is copyright and may not be reproduced without the written consent of Tasse Homes. Drafted by Phil Chamberlain, re/design Architecture - 0236607

DRAWING: FLOOR PLAN
DATE: 11/02/20
FILE NAME: H204 DA 140122.dwg
DRAWN BY: PC

DWG No: