



60 Old Summerleas Road Kingston TAS

3 2 6

Maria Gigney's architectural masterpiece, nestled within 8.1 acres of pristine bushland, stands as a testament to sustainable luxury and tranquillity. The property's solar passive design, coupled with its stunning views of Mount Wellington/kunanyi and the surrounding hills, creates an enchanting ambiance that captivates from every angle.

At 228 square meters, the main residence offers three bedrooms, two bathrooms, and expansive open-plan living areas that seamlessly merge to encourage gatherings and relaxation against a backdrop of panoramic vistas. The abundance of natural light, facilitated by double-glazed windows and doors, not only showcases the spectacular views but also enhances energy efficiency and insulation.

The heart of the home resides in its spacious commercial kitchen, equipped with European appliances, where

Price : Best Offer Over \$3,700,000
Building Size : 228 sqm
Land Size : 32800 sqm
View : <https://www.taspr.com.au/7979236>



Renee Vanson
03 6264 2888

<https://www.taspr.com.au>

(03) 6264 2888

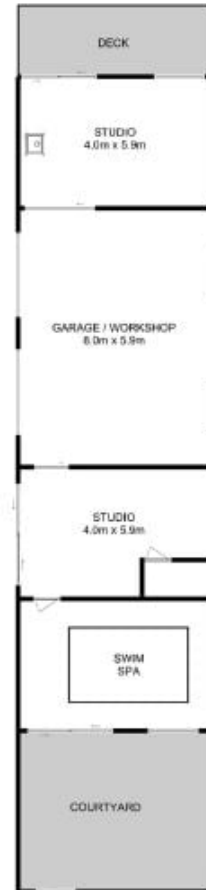

Total Approx. Floor Area : 234 sqm
Total Approx. Outbuilding Area : 158 sqm

All measurements are internal and approximate.
This plan is a sketch for illustration, not valuation.
Produced by Open2view.com